

NOTES:

Schedule 'A' should be read in conjunction with Schedules 'B-1A' through 'B-12', Schedule 'C', Schedule 'D' and the text of the Official Plan.

Schedules 'B-1A' through 'B-12' are details of the Schedule 'A' Land Use Plan and are delineated accordingly.

Produced by Monteth Planning Consultants under License with the Ministry of Natural Resources Queen's Printer for Ontario, 2000

This product has been created using copyright data owned by the Grand River Conservation Authority. The data is being used under licence by Monteth Planning Consultants.

This product has been created using data owned by the Longpoint Region Conservation Authority

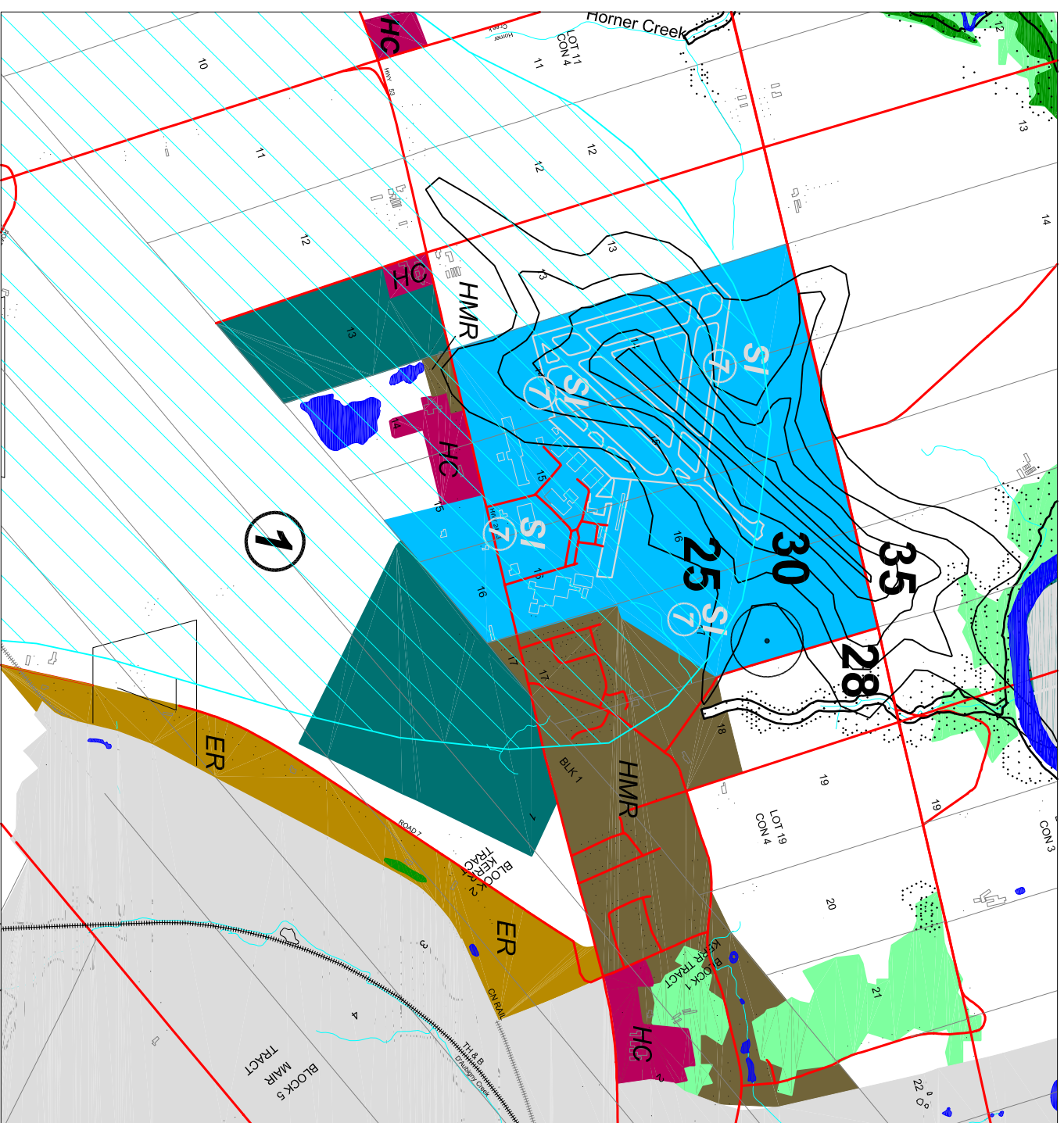

AIRPORT / OAKHILL SETTLEMENT AREA

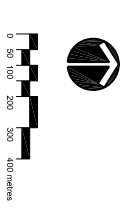

COUNTY OF BRANT
OFFICIAL PLAN
SCHEDULE 'B-9'
LAND USE PLAN



LEGEND

- AGRICULTURAL
- NATURAL ENVIRONMENT**
 - LOCAL Y SIGNIFICANT
 - PROVINCIAL Y SIGNIFICANT
 - LIFE SCIENCE ANSI
 - REGIONALLY SIGNIFICANT
 - LIFE SCIENCE ANSI
 - PROVINCIAL Y SIGNIFICANT
 - EARTH SCIENCE ANSI
 - FLOOD PRONE AREA AND STEEP SLOPE AREA
 - FLOOD LINES
 - FILL LINE
- WETLANDS (Provincially Significant)
- WOODLANDS
- EXTRACTIVE INDUSTRIAL
- LOW DENSITY RESIDENTIAL
- MEDIUM DENSITY RESIDENTIAL
- HIGH DENSITY RESIDENTIAL
- OFFICE RESIDENTIAL
- HERITAGE RESIDENTIAL
- HAMLET RESIDENTIAL
- HMR
- HMRG
- ER
- MODULAR HOME PARK
- RECREATIONAL TRAILER PARK
- NEIGHBOURHOOD COMMERCIAL
- HIGHWAY COMMERCIAL
- SHOPPING CENTRE COMMERCIAL
- GENERAL COMMERCIAL
- LIGHT INDUSTRIAL
- SPECIAL INDUSTRIAL
- HEAVY INDUSTRIAL
- INSTITUTIONAL
- RECREATIONAL
- WELL HEAD PROTECTION AREA (WHPA)
- AREAS EXCLUDED FROM PLAN
- LAKES, RIVERS, RESERVOIRS
- SETTLEMENT BOUNDARY
- FUTURE GROWTH DIRECTION
- SPECIAL POLICIES
- TRAIL
- NOISE EXPOSURE FORECAST CONTOUR
- COLD WATER RIVERS AND STREAMS
- WARMWATER RIVERS AND STREAMS
- RAILWAY LINE
- ABANDONED RAILWAY LINE
- LANDFILL SITES 500m RADIUS
- SEWAGE TREATMENT PLANTS 150m RADIUS